

PRICE CHOPPER SHOPPING CENTER

Pad Building For Lease - Immediate Occupancy



900 - 3,358 Sq Ft Available

Quivira Road at 133rd Street, Overland Park, Kansas | A Greater Kansas City Suburb



- 3,358 Sq Ft space can be split
- Adjacent to national retailers including CVS Pharmacy, McDonald's, Taco Bell, Arby's, Goodyear, Phillips 66, and many more
- At main entrance to Price Chopper Grocery anchored shopping center and across the street from the 40,000 +/- sq ft Fieldhouse of Kansas City Indoor Sports Facility
- Excellent visibility from Quivira Road and direct access to 133rd Street
- Over 24,010 employees work within a 3 mile radius
- Intersection carries over 45,000 cars per day
- Minutes from Deanna Rose Farmstead, Overland Park Sports Complex, St. Andrew's Golf Course, and more

Estimated Population
210,063

Average Household Income
\$103,429

Five Mile Radius

BLOCK & COMPANY, INC., Realtors 816.753.6000
In the Skelly Building on the Country Club Plaza
605 West 47th Street, Suite 200, Kansas City, Missouri 64112

For Information Contact:

Darren Siegel
816.412.7377
dsiegel@blockandco.com

David Block
816.412.7400
dblock@blockandco.com

Max Kosoglad
816.412.7363
mkosoglad@blockandco.com

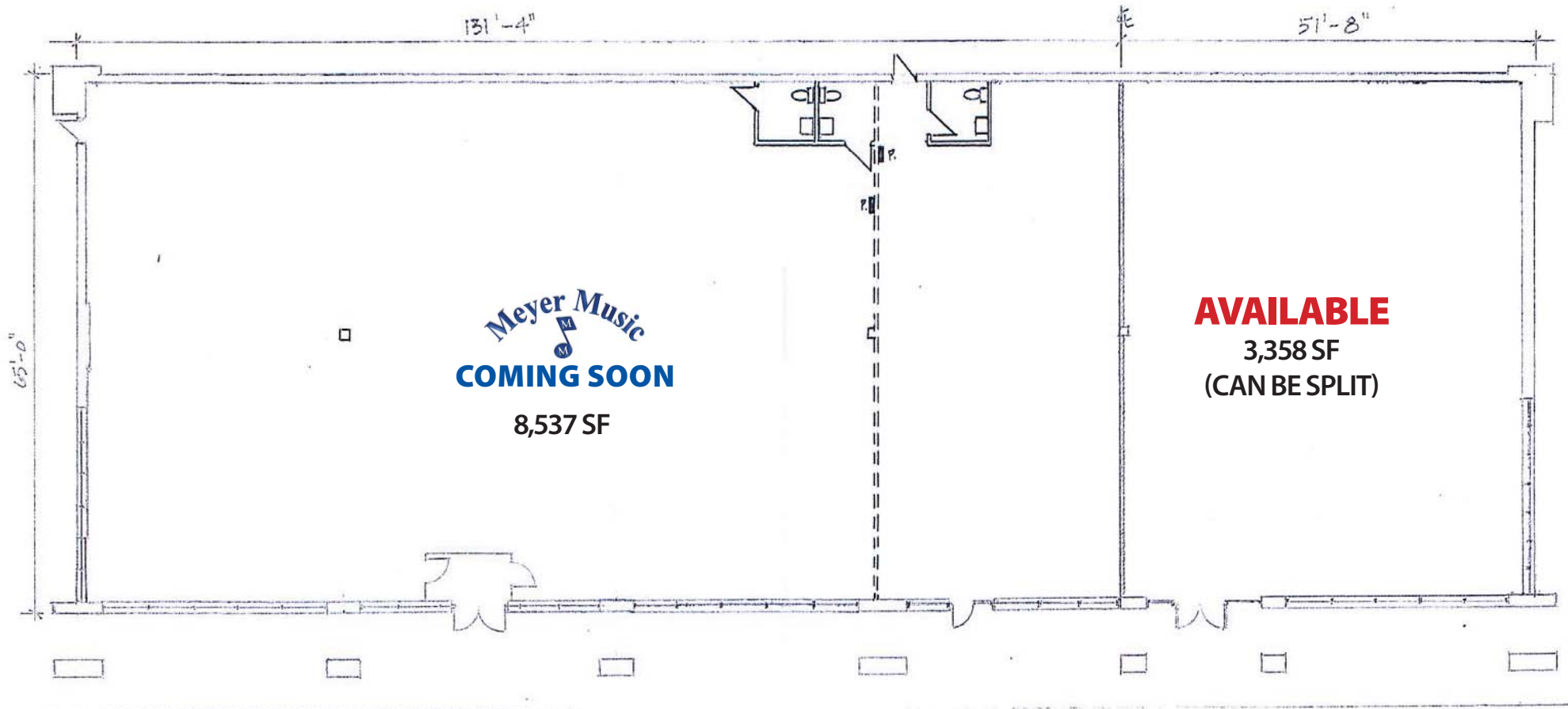

DISCLAIMER;
ALL DIMENSIONS MUST BE INDEPENDENTLY FIELD VERIFIED. THIS PLAN
IS NOT INTENDED FOR CONSTRUCTION.

< NORTH NOT TO SCALE 8-14-2013 REVISED 9-4-13

Quivira Road at 133rd Street, Overland Park, Kansas



NEIGHBORING TENANTS



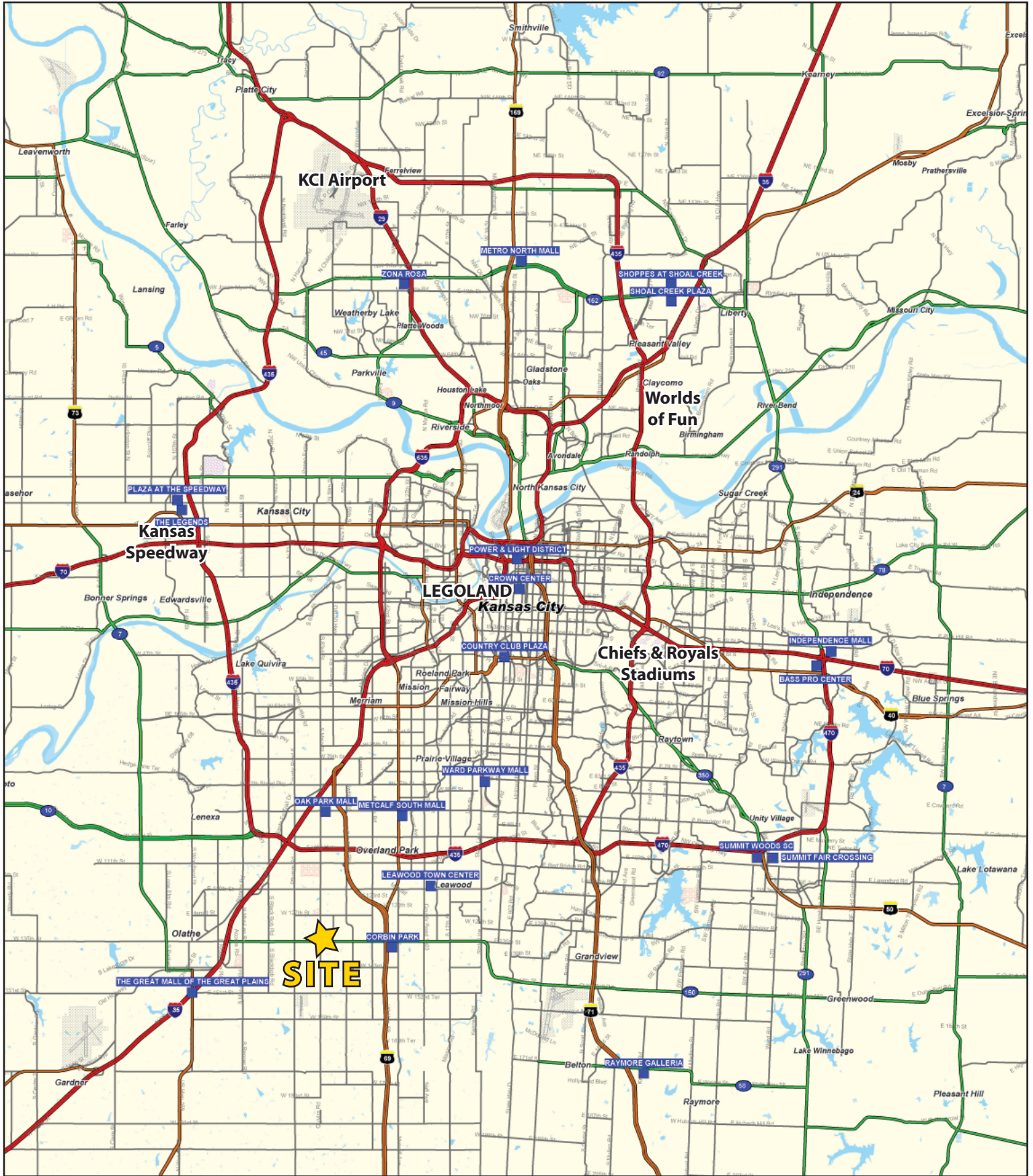

SUMMARY DEMOGRAPHIC PROFILE

- Census, 2011 Estimates & 2016 Projections

Calculated using Proportional Block Groups

Lat/Lon: 38.883675/-94.72372

RS1

133rd Street & Quivira Road Overland Park, Kansas		1.00 mi radius	3.00 mi radius	5.00 mi radius
POPULATION	2011 Estimated Population	8,460	89,434	210,063
	2016 Projected Population	9,459	95,641	222,401
	Census Population	6,178	69,153	171,158
	Census Population	460	28,444	107,357
	Historical Annual Growth to 2011	82.8%	10.2%	4.6%
	Projected Annual Growth 2011 to 2016	2.4%	1.4%	1.2%
	2011 Median Age	33.7	35.0	35.3
HOUSEHOLDS	2011 Estimated Households	2,881	33,602	81,028
	2016 Projected Households	3,363	37,278	88,902
	Census Households	1,846	24,144	62,353
	Census Households	148	10,066	38,396
	Historical Annual Growth to 2011	88.1%	11.1%	5.3%
	Projected Annual Growth 2011 to 2016	3.3%	2.2%	1.9%
POPULATION BY RACE	2011 Estimated White	87.4%	84.2%	83.5%
	2011 Estimated Black or African American	2.3%	4.0%	4.7%
	2011 Estimated Asian & Pacific Islander	7.6%	7.7%	6.4%
	2011 Estimated American Indian & Native Alaskan	0.3%	0.3%	0.3%
	2011 Estimated Other Races	2.4%	3.8%	5.0%
	2011 Estimated Hispanic	2.9%	5.2%	7.4%
INCOME	2011 Estimated Average Household Income	\$ 153,547	\$ 112,951	\$ 103,429
	2011 Estimated Median Household Income	\$ 130,674	\$ 97,098	\$ 86,620
	2011 Estimated Per Capita Income	\$ 52,297	\$ 42,477	\$ 40,100
EDUCATION (AGE 25+)	2011 Elementary	1.2%	0.9%	1.3%
	2011 Some High School	0.9%	1.8%	2.6%
	2011 High School Graduate	9.5%	12.8%	14.3%
	2011 Some College	14.3%	17.5%	19.8%
	2011 Associates Degree Only	4.0%	6.5%	6.9%
	2011 Bachelors Degree Only	45.0%	39.8%	36.5%
	2011 Graduate Degree	25.1%	20.7%	18.6%
BUSINESS	Number of Businesses	129	2,009	8,611
	Total Number of Employees	1,157	24,010	144,264
	Employee Population per Business	8.9	12.0	16.8
	Residential Population per Business	65.4	44.5	24.4

This report was produced using data from private and government sources deemed to be reliable. The information herein is provided without representation or warranty.